

ATTACHMENT A
AMENDED CHALET PLANS

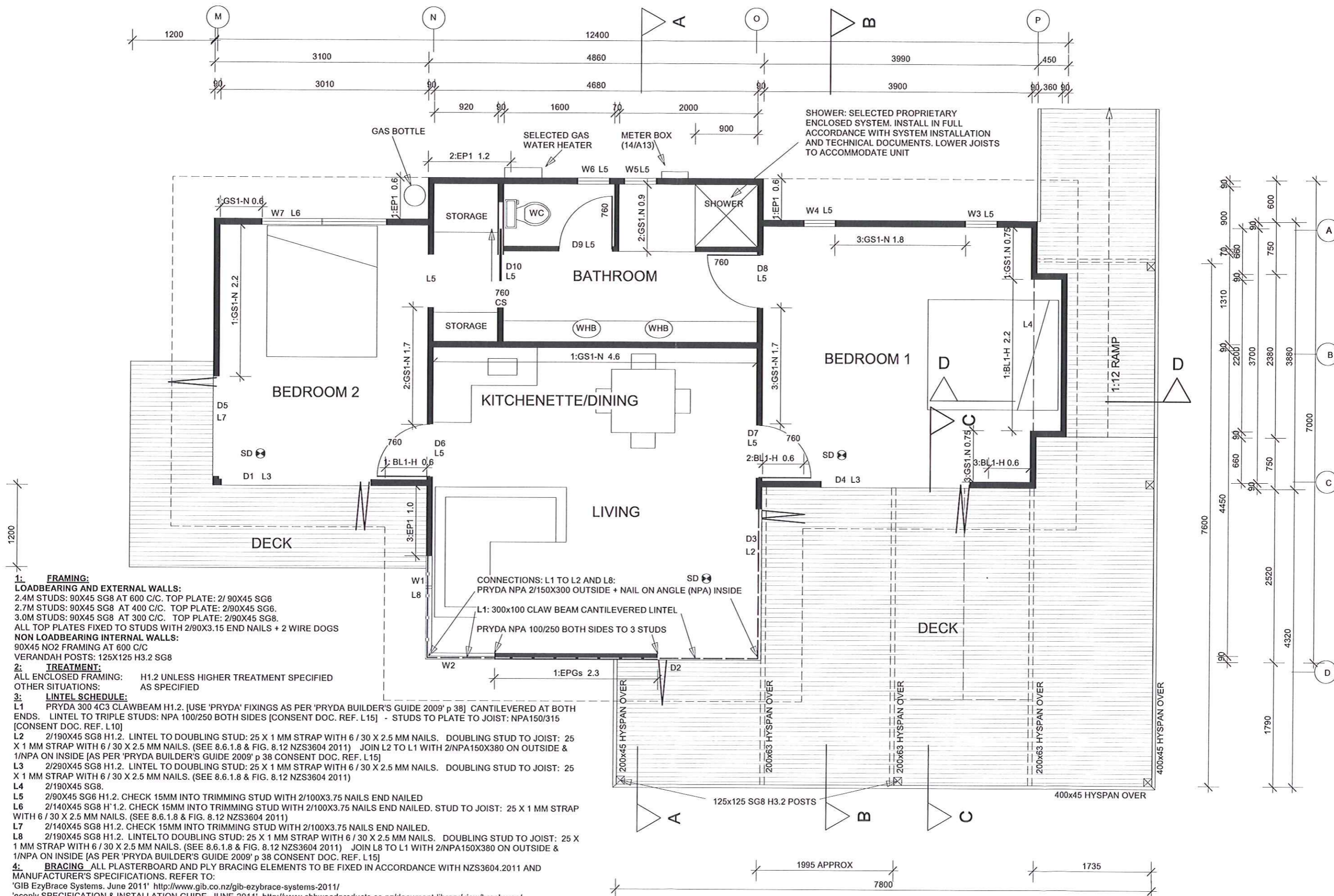

PLANNERS PLUS LIMITED

Land Development, Resource Consent and Planning Specialists.



1: FRAMING:

LOADBEARING AND EXTERNAL WALLS:

2.4M STUDS: 90X45 SG8 AT 600 C/C. TOP PLATE: 2/ 90X45 SG6
 2.7M STUDS: 90X45 SG8 AT 400 C/C. TOP PLATE: 2/90X45 SG6.
 3.0M STUDS: 90X45 SG8 AT 300 C/C. TOP PLATE: 2/90X45 SG6.
 ALL TOP PLATES FIXED TO STUDS WITH 2/90X3.15 END NAILS + 2 WIRE DOGS
NON LOADBEARING INTERNAL WALLS:
 90X45 NO2 FRAMING AT 600 C/C
 VERANDAH POSTS: 125X125 H3.2 SG8

2: TREATMENT:

ALL ENCLOSED FRAMING: H1.2 UNLESS HIGHER TREATMENT SPECIFIED
 OTHER SITUATIONS: AS SPECIFIED

3: LINTEL SCHEDULE:

L1 PRYDA 300 4C3 CLAWBEAM H1.2. [USE 'PRYDA' FIXINGS AS PER 'PRYDA BUILDER'S GUIDE 2009' p 38] CANTILEVERED AT BOTH ENDS. LINTEL TO TRIPLE STUDS: NPA 100/250 BOTH SIDES [CONSENT DOC. REF. L15] - STUDS TO PLATE TO JOIST: NPA150/315 [CONSENT DOC. REF. L10]
 L2 2/190X45 SG8 H1.2. LINTEL TO DOUBLING STUD: 25 X 1 MM STRAP WITH 6 / 30 X 2.5 MM NAILS. DOUBLING STUD TO JOIST: 25 X 1 MM STRAP WITH 6 / 30 X 2.5 MM NAILS. (SEE 8.6.1.8 & FIG. 8.12 NZS3604 2011) JOIN L2 TO L1 WITH 2/NPA150X380 ON OUTSIDE & 1/NPA ON INSIDE [AS PER 'PRYDA BUILDER'S GUIDE 2009' p 38 CONSENT DOC. REF. L15]
 L3 2/290X45 SG8 H1.2. LINTEL TO DOUBLING STUD: 25 X 1 MM STRAP WITH 6 / 30 X 2.5 MM NAILS. DOUBLING STUD TO JOIST: 25 X 1 MM STRAP WITH 6 / 30 X 2.5 MM NAILS. (SEE 8.6.1.8 & FIG. 8.12 NZS3604 2011)
 L4 2/190X45 SG8.
 L5 2/90X45 SG6 H1.2. CHECK 15MM INTO TRIMMING STUD WITH 2/100X3.75 NAILS END NAILED
 L6 2/140X45 SG8 H1.2. CHECK 15MM INTO TRIMMING STUD WITH 2/100X3.75 NAILS END NAILED. STUD TO JOIST: 25 X 1 MM STRAP WITH 6 / 30 X 2.5 MM NAILS. (SEE 8.6.1.8 & FIG. 8.12 NZS3604 2011)
 L7 2/140X45 SG8 H1.2. CHECK 15MM INTO TRIMMING STUD WITH 2/100X3.75 NAILS END NAILED.
 L8 2/190X45 SG8 H1.2. LINTEL TO DOUBLING STUD: 25 X 1 MM STRAP WITH 6 / 30 X 2.5 MM NAILS. DOUBLING STUD TO JOIST: 25 X 1 MM STRAP WITH 6 / 30 X 2.5 MM NAILS. (SEE 8.6.1.8 & FIG. 8.12 NZS3604 2011) JOIN L8 TO L1 WITH 2/NPA150X380 ON OUTSIDE & 1/NPA ON INSIDE [AS PER 'PRYDA BUILDER'S GUIDE 2009' p 38 CONSENT DOC. REF. L15]

4: BRACING:

ALL PLASTERBOARD AND PLY BRACING ELEMENTS TO BE FIXED IN ACCORDANCE WITH NZS3604.2011 AND MANUFACTURER'S SPECIFICATIONS. REFER TO:
 'GIB EzyBrace Systems. June 2011' <http://www.gib.co.nz/gib-ezybrace-systems-2011/>
 'ecopy SPECIFICATION & INSTALLATION GUIDE. JUNE 2011' <http://www.chhwoodproducts.co.nz/document-library/view/brochures/>

5: INSULATION

ROOF: R2.6 PINK BATTS. WALLS: R2.4 PINK BATTS. FLOOR: POLYSTYRENE EPS 60MM INS GRADE

6: WATER SPLASH

IMPERVIOUS FINISH AND SEALED JOINTS TO FLOOR AND ALL WALLS SUBJECT TO WATER SPLASH IN BATHROOM, AND KITCHENETTE

7: SMOKE ALARMS

SEAL SMOKE ALARM ON CEILING AT LEAST 300mm AWAY FROM WALLS OR CORNERS OR ON WALLS 100mm FROM CEILING. REFER TO FIRE SERVICE WEBSITE <http://www.fire.org.nz/> FOR RECOMMENDED ALARM STANDARDS

It is the responsibility of all Contractors, Sub-contractors and Suppliers to verify all dimensions on site prior to commencement of any works. Dimensions are not to be scaled from these drawings.

LUSBY DWELLING. LOT 35, SILVERSTREAM FALLS, SH25 TAIRUA		Drawing: FLOOR PLAN	
Sheet Number: A03	Scale: 1:50@A3	Drawn by: AK	Date: 20.01.12
		<i>mamaku design ltd</i> PH & FAX 07 866 3141 027 2820282 andykimber@gmail.com 320 BOAT HARBOUR ROAD, RD1 WHITIANGA 3591	